



Maisonette

SANDERS LANE MILL HILL LONDON NW7 1BD

PCM

£1,800 PCM

FEATURES



2 Bedroom Maisonette located in London

Call us on

0208 959 0000

info@maxwellestates.co.uk

www.maxwellestates.co.uk

Maxwell Estates are delighted to offer this newly part-refurbished two bedroom first floor maisonette located in the desirable area of Mill Hill East. This well-presented property comprises a bright reception room, a kitchen, two bedrooms and a bathroom.

Access is via stairs only. A standout feature of this home is the large private garden, offering an abundance of outdoor space ideal for entertaining, relaxing, or family use.

The property is conveniently located close to essential amenities and offers excellent transport links Mill Hill East Station - Northern line), making it suitable for commuters and families alike.

Summary:

Newly part-refurbished

First floor maisonette

Stair access only

Council Tax Band

C

Approx Gross Internal Area
58 sq m / 629 sq ft

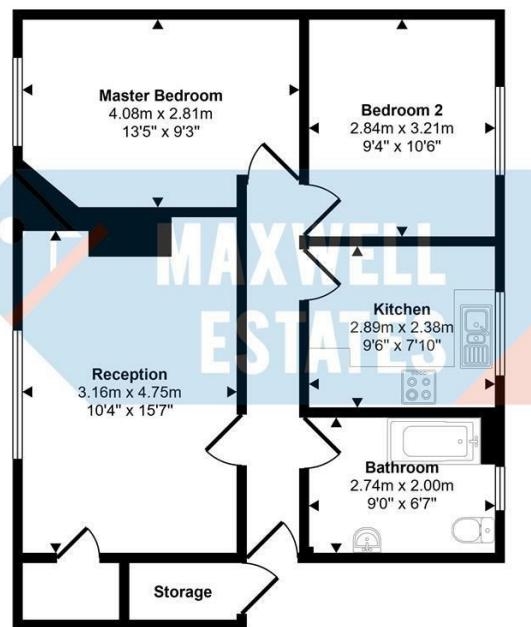

First Floor

This floorplan is only for illustrative purposes and is not to scale. Measurements of rooms, doors, windows, and any items are approximate and no responsibility is taken for any error, omission or mis-statement. Icons of items such as bathroom suites are representations only and may not look like the real items. Made with Made Snappy 360.

Energy Efficiency Rating		Current	Potential
<i>Very energy efficient - lower running costs</i>			
(92 plus) A			
(81-91) B			
(69-80) C			
(55-68) D			
(39-54) E			
(21-38) F			
(1-20) G			
<i>Not energy efficient - higher running costs</i>			
England & Wales		EU Directive 2002/91/EC	

Agents Note: Whilst every care has been taken to prepare these particulars, they are for guidance purposes only. All measurements are approximate and are for general guidance purposes only and whilst every care has been taken to ensure their accuracy, they should not be relied upon and potential buyers are advised to recheck the measurements.

