

LEASEHOLD



Not specified

**BURNT OAK  
BROADWAY,  
EDGWARE  
HA8 5EJ**

**£225,000**

FEATURES



# 1 Bedroom Not specified located in Edgware

Maxwell Estates are delighted to bring to the market this one-bedroom flat situated in the heart of Burnt Oak Broadway.

The property features a Spacious living room, ideal for relaxing or entertaining, a separate well-equipped kitchen, and a bathroom. The bedroom is well-proportioned, making the flat suitable for professionals and couples

Additional benefits include parking facilities and access to good local schools. The flat is ideally located close to a range of local amenities, including shops and services, and is within easy reach of the tube station (Northern Line), providing excellent transport links.

To arrange a viewing, please contact the sales team at Maxwell Estates today.

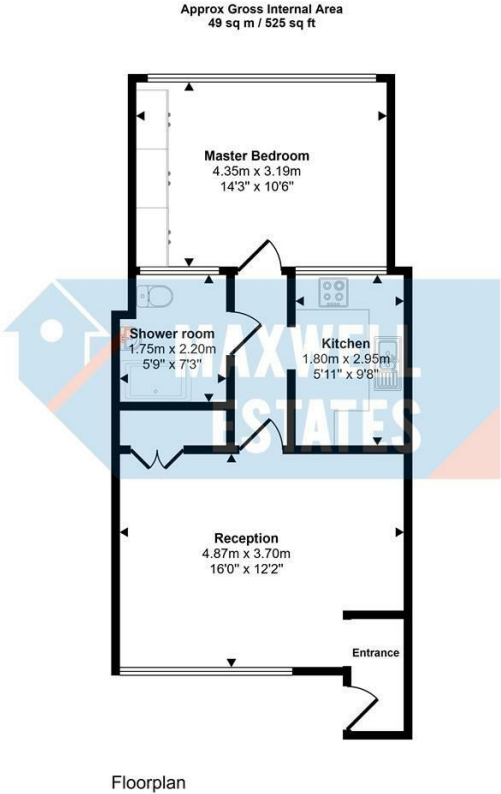

This floorplan is only for illustrative purposes and is not to scale. Measurements of rooms, doors, windows, and any items are approximate and no responsibility is taken for any error, omission or mis-statement. Icons of items such as bathroom suites are representations only and may not look like the real items. Made with Made Snappy 360.

Call us on  
**0208 952 0808**  
[info@maxwellestates.co.uk](mailto:info@maxwellestates.co.uk)  
[www.maxwellestates.co.uk](http://www.maxwellestates.co.uk)

Council Tax Band  
**C**

Energy Efficiency Rating		
	Current	Potential
Very energy efficient - lower running costs		
(92 plus) <b>A</b>		
(81-91) <b>B</b>		
(69-80) <b>C</b>		
(55-68) <b>D</b>		
(39-54) <b>E</b>		
(21-38) <b>F</b>		
(1-20) <b>G</b>		
Not energy efficient - higher running costs		
England & Wales		EU Directive 2002/91/EC

Agents Note: Whilst every care has been taken to prepare these particulars, they are for guidance purposes only. All measurements are approximate and are for general guidance purposes only and whilst every care has been taken to ensure their accuracy, they should not be relied upon and potential buyers are advised to recheck the measurements.

